

The scaling of this drawing cannot be assured

Revision	Date	Initial
A	07.08.2015	CS
B	04.09.2015	CS

GENERAL NOTES

- THIS DRAWING IS TO BE READ IN CONJUNCTION WITH ALL GENERAL ARRANGEMENT DRAWINGS, PROJECT DETAILS AND SPECIFICATIONS.
- ALL DIMENSIONS TO BE CHECKED ON SITE PRIOR TO THE FABRICATION OF ANY WORK AND/OR ORDERING ANY MATERIAL. UNLESS NOTED OTHERWISE, ALL DIMENSIONS ARE TO STRUCTURAL FACES AND/OR PARTITION STUDS.
- ABBREVIATIONS USED:-  
 MJ MOVEMENT JOINT  
 HL AT HIGH LEVEL  
 AAV AIR ADMITTANCE VALVE  
 SVP SOIL AND VENT PIPE  
 DP DRAINAGE POINT  
 RWP RAIN WATER PIPE
- LEGEND

- EXISTING WALLS TO BE RETAINED. ALL DAMAGED AND UNEVEN EXISTING FINISHES TO BE REMOVED AND TO BE REPLACED WITH SIMILAR NEW.
- EXISTING BLOCK WORK
- EXISTING FACING BRICKWORK
- EXISTING WALLS TO BE REMOVED WITH THE INSTRUCTION OF STRUCTURE ENGINEER. STEEL BEAM / STRUCTURAL SUPPORT TO BE PROVIDED TO ENGINEER'S DESIGN AND DETAILS

WALL TYPE 1 - EXTERNAL CAVITY WALL  
 140mm THERMALITE AIRCRETE HI-STRENGTH 7 BLOCK MINIMUM BLOCK STRENGTH TO BE 7.3 N/SQ.MM. TO BE CONFIRMED AND DETAILED BY THE STRUCTURAL ENGINEERS DETAILS. 100MM CAVITY WITH 50MM CELOTEX CG 5000 INSULATION. OUTER LEAF TO BE 102.5MM FACING BRICK WORK TO MATCH EXISTING. INTERNAL FINISH TO BE DRYLINER BASIC SYSTEM - 15MM DURALINE PLASTERBOARD READY TO RECEIVE DECORATION.

WALL TYPE 2 - LOAD BEARING INTERNAL WALL  
 140mm THERMALITE AIRCRETE HI-STRENGTH 7 BLOCK WITH 2 X 12.5MM GYPROC SOUNDBLOC PLASTERBOARD EACH SIDE. MINIMUM BLOCK STRENGTH TO BE 7.3 N/SQ.MM. TO BE CONFIRMED AND DETAILED BY THE STRUCTURAL ENGINEERS DETAILS.

WALL TYPE 3 - INTERNAL PARTITION (GROUND FLOOR)  
 LOAD-BEARING PARTITION WALL - 100MM THERMALITE AIRCRETE HI-STRENGTH 7 BLOCK MINIMUM BLOCK STRENGTH TO BE 7.3 N/SQ.MM. TO BE CONFIRMED AND DETAILED BY THE STRUCTURAL ENGINEERS DETAILS. 1NO. 12.5MM SOUNDBLOC RAPID BOARD ON EACH SIDE AND APPLY CERAMIC TILES WITH ADHESIVE WHERE SPECIFIED.

WALL TYPE 4 - INTERNAL PARTITION (GROUND FLOOR)  
 LOAD-BEARING PARTITION WALL - 100MM THERMALITE AIRCRETE HI-STRENGTH 7 BLOCK MINIMUM BLOCK STRENGTH TO BE CONFIRMED AND DETAILED BY THE STRUCTURAL ENGINEERS DETAILS. 1NO. 12.5MM SOUNDBLOC RAPID BOARD ON EACH SIDE OR APPLY CERAMIC TILES DIRECTLY TO THE BLOCK WITH ADHESIVE.

WALL TYPE 5 - INTERNAL PARTITION (FIRST FLOOR)  
 NON-LOADBEARING PARTITION - 70MM GYFRAME 'C' STUDS AT 600MM CENTRES WITH GYFRAME R81 RESILIENT BAR AT 600MM CENTRES TO ONE SIDE. 50MM ISOVER AFR 1200 IN THE CAVITY. 1 X 18MM PLANK BOARD AND 1 X 12.5MM SOUNDBLOC RAPID BOARD ON EACH SIDE. CONSTRUCTION AS PER A316011 THE WHITE BOOK. SOUND INSULATION Rw D8 65 90MIN FIRE RESISTANCE. ALL JOINTS TAPED AND FILLED, OR SKIMMED ACCORDING TO BRITISH GYPSUM'S RECOMMENDATIONS. MR GRADE BOARD TO BE USED IN WET AREAS. PLY INFILL BETWEEN STUDS TO BE USED TO SUPPORT BATHROOM / KITCHEN WALL UNITS ALL IN ACCORDANCE WITH THE CLIENTS SPECIFICATION.

SB DENOTES STRUCTURAL BEAM OVER FOR ALL STRUCTURAL STEELWORK, PARTITIONS AND MOVEMENT JOINT DETAILS REFER TO THE STRUCTURAL ENGINEER'S DRAWINGS.

ALL DRAINAGE RUNS TO BE ABOVE FLOOR UNLESS STATED OTHERWISE. ALL DRAINAGE TO BE CONFIRMED AND DETAILED BY M&E ENGINEER.

KITCHEN LAYOUT TO SPECIALIST'S DESIGN AND DETAILS

FOR MOVEMENT JOINT, BED JOINT REINFORCEMENT AND ALL STRUCTURAL INFORMATION REFER TO STRUCTURAL ENGINEERS DRAWINGS AND DETAILS

TRUSSES AND ROOF DESIGN TO BE CONFIRMED OR DESIGNED BY SPECIALISTS.

ELECTRIC AND MAE WORK TO BE CARRIED OUT BY QUALIFIED AND REGISTERED SPECIALIST.

ALL EXTERNAL MATERIALS TO MATCH WITH THE EXISTING. ALL DETAILS TO BE CONFIRMED BEFORE PLACING ANY ORDER FOR MATERIALS OR COMMENCEMENT OF WORK ON SITE.

ALL WALLS WHICH NEED TO BE REMOVED, SHOULD BE CARRIED OUT AS PER ENGINEER'S INSTRUCTIONS

STATUS  
**BUILDING\_CONTROL**

Project  
 112\_BALFOUR\_ROAD  
 ILFORD\_IG1\_4JE

Drawing Title  
**GENERAL\_ARRANGEMENT**  
 PROPOSED\_FIRST\_FLOOR\_SETTING\_OUT\_PLAN

Date	Scale	Drawn by
MAY_2015	1:50@A1	CS
Project No	Drawing No	Revision
343	343-13-01	B

**ARCHITORIUM** LIMITED  
 ARCHITECTURE, PROJECT  
 MANAGEMENT & CONSTRUCTION  
 MANAGEMENT  
 3rd Floor, Ferguson House  
 113 Cranbrook Road, Ilford, Essex. IG1 4PU  
 Contact : 020 3362 4200  
 www.architorium.co.uk

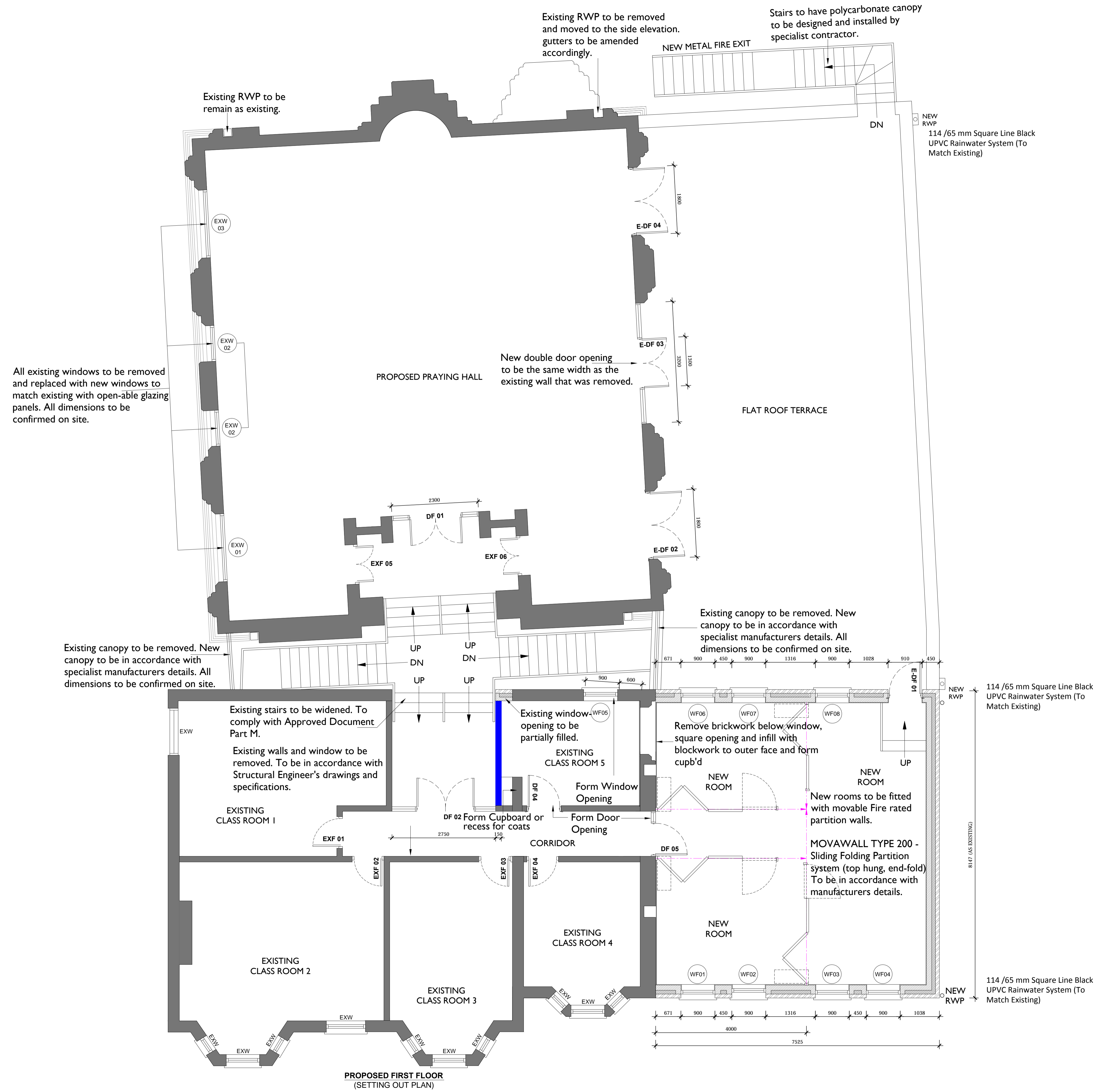

PROPOSED FIRST FLOOR  
 (SETTING OUT PLAN)